

MTxx-NIRxx-Fio-xx

PRODUCT OVERVIEW

These fiber pigtailed devices are meant to be used for a single wavelength within their range of operation [780-870 nm]. They can be used for intensity modulation, fixed or variable frequency shifting, pulse picking or q-switching. AA offers a complete range with different carrier frequencies, different rise times, input optical power. Moreover, in order to meet most requirements, user can select the fiber type, fiber jacket and fiber connectors among the proposed ones.

FEATURES

- High Speed.
- High Extinction ratio.
- Robust & versatile.

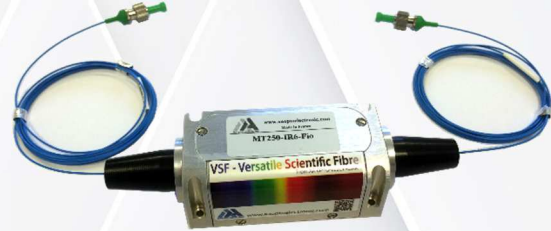

SPECIFICATIONS (T=25°C)

PARAMETER	RATING	UNIT
Material	TeO ₂ -L - 4200	m/s
Optical Wavelength range (λ)*	780-870*	nm
Input / Output Polarization	Linear (PM fibres), random (SM fibres)	
Polarisation dependence losses (PDL)	<0.5	dB
Static Extinction Ratio	>45	dB
Jacket type	900 μm Hytrel Tubing or 3 mm PVC or 3 mm Stainless Steel	
Fiber type	HI 780 or PM850	
Fiber connectors**	FC/APC **or Super FC/PC**	
Pigtailed Length IN/OUT	1	m
Input impedance	50	Ω
V.S.W.R	1.2/1	
RF Connector	SMA	
Size	89 x 46.6 x 32.5	mm
Weight	250	g
Packaging	IN PRO 334	
RoHS Compliance	Yes	

*single wavelength to be specified within that range.

**While internal termination is designed for high optical power, we recommend removing the connectors and splicing the fiber for full power optical power handling.

	MT80-NIR60-Fio-xx	MT110-NIR20-Fio-xx	MT200-NIR10-Fio-xx	MT250-NIR6-Fio-xx
Frequency Shift (MHz)	+80 or -80	+110 or -110	+200 or -200	+250 or -250
Insertion losses (dB)	< 3	< 3.5	< 5	< 6
Rise/fall time (ns)	60	20	10	6
Max optical power(W)	0.5 or 2	0.5 or 1	0.5	0.2
Maximum RF power(W)	<2	<2	< 2	< 1.8
Variable Frequency Shift	On Request	On Request	On Request	On Request

MTxx-NIRxx-Fio-xx

OUTLINE DRAWING, mm

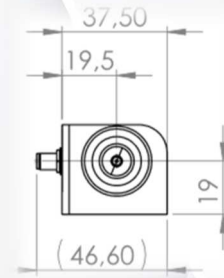
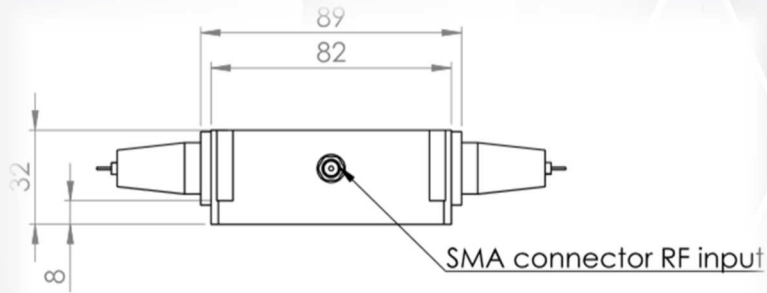

4x FIXING HOLES FOR SCREWS M2.5

